

IMPORTANT NOTES

- A. HEADER BOX MUST BE FIELD PREPPED FOR INSTALLATION. FASTENING HARDWARE DEPENDANT UPON MOUNTING SURFACE OR WALL STRUCTURE OF INSTALLATION AREA IS NOT SUPPLIED.
- B. ACCESS HOLES ARE GENERALLY LOCATED THROUGH THE BACK OF THE HEADER BOX FOR CLEAN CONCEALED LOOK; ALTERNATIVELY THEY CAN BE THROUGH THE TOP OR ENDPLATE OF THE BOX WITH WIRING RUN THROUGH CODE APPROVED SURFACE CONDUIT.
1. ELECTRICAL SERVICE AND ALL HARD WIRING TO BE SUPPLIED BY QUALIFIED PROFESSIONAL CONTRACTOR WITHIN THE GUIDELINES OF THE ENFORCED LOCAL ELECTRICAL CODES.
2. ACCESS HOLES ARE ALWAYS AWAY FROM HINGE SIDE OF HEADER TO ENSURE CABLES & WIRING RUNS DO NOT INTERFERE WITH & GET CHAFED BY THE MECHANICS OF THE OPERATOR WITHIN THE HEADER.
3. HIGH VOLTAGE INCOMING POWER & LOW VOLTAGE WIRES CANNOT SHARE THE SAME ACCESS HOLE. HIGH VOLTAGE WIRES MUST BE ROUTED IN CONDUIT & SECURED AWAY FROM ALL LOW VOLTAGE WIRES.
4. IF HEADER IS MOUNTED ON ALUMINUM FRAMING, HIGH & LOW VOLTAGE WIRING CAN BE ROUTED THROUGH VERTICAL & HORIZONTAL TUBES.
5. INCOMING (MAIN) POWER GROUND WIRE CANNOT SHARE THE SAME GROUNDING STUD AS SYSTEM GROUND WIRE. GROUND INCOMING (MAIN) POWER ACCORDINGLY.

APPLICATION: FA-8 FULLY AUTOMATIC WIRING REQUIREMENTS

NOTE:
AUTOMATIC SWING DOOR OPERATOR SHALL BE "FA-8" CETL USA APPROVED, CONFORMING TO UL STD. 325 & ANSI-BHMA STD. A156.10 CERTIFIED TO CAN. CSA STD. C22.2#247 AS MANUFACTURED BY HUNTER ACCESS TECHNOLOGIES INC.
COMPLETE DOOR SYSTEM MUST MEET ANSI A156.10 STANDARDS
STANDARD FINISH: CLEAR ANODIZE, DARK BRONZE,
SPECIAL FINISHES ARE AVAILABLE

MAIN INCOMING POWER, (MIP)
120V AC. 60HZ. 15A. BY
ELECTRICAL CONTRACTOR

LOW VOLTAGE WIRING, (LVW)
SEPARATE FROM INCOMING
MAIN POWER TO CONTROL

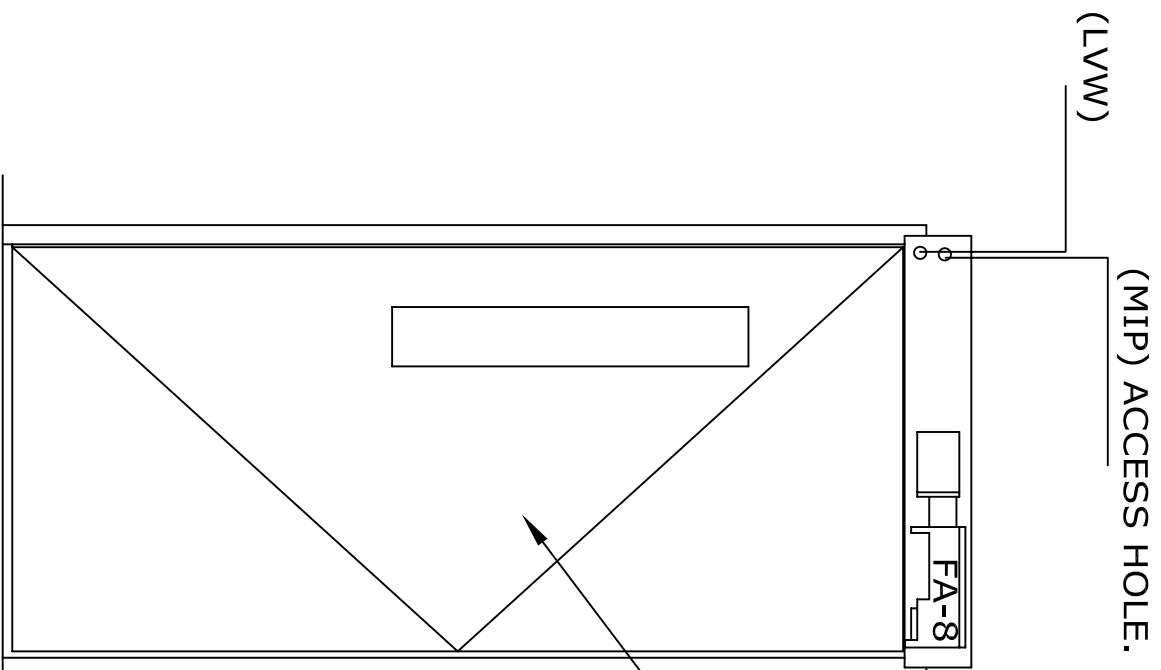

TYP. RIGHT HAND
APPLICATION IS
SHOWN. (LEFT
HAND OPPOSITE).

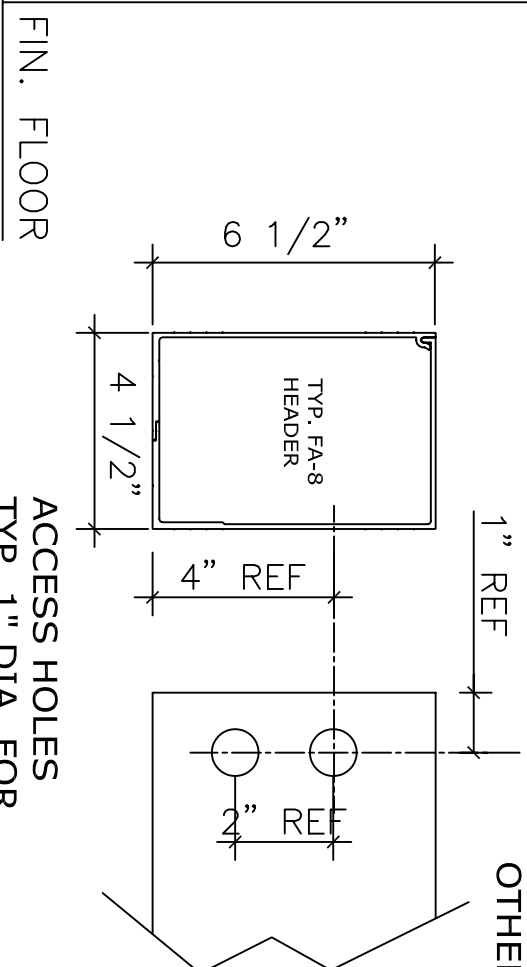

SWING HOLLOW
METAL, ALUMINUM
OR WOOD DOORS
AND FRAMES BY
OTHERS TYP.

ELEVATION

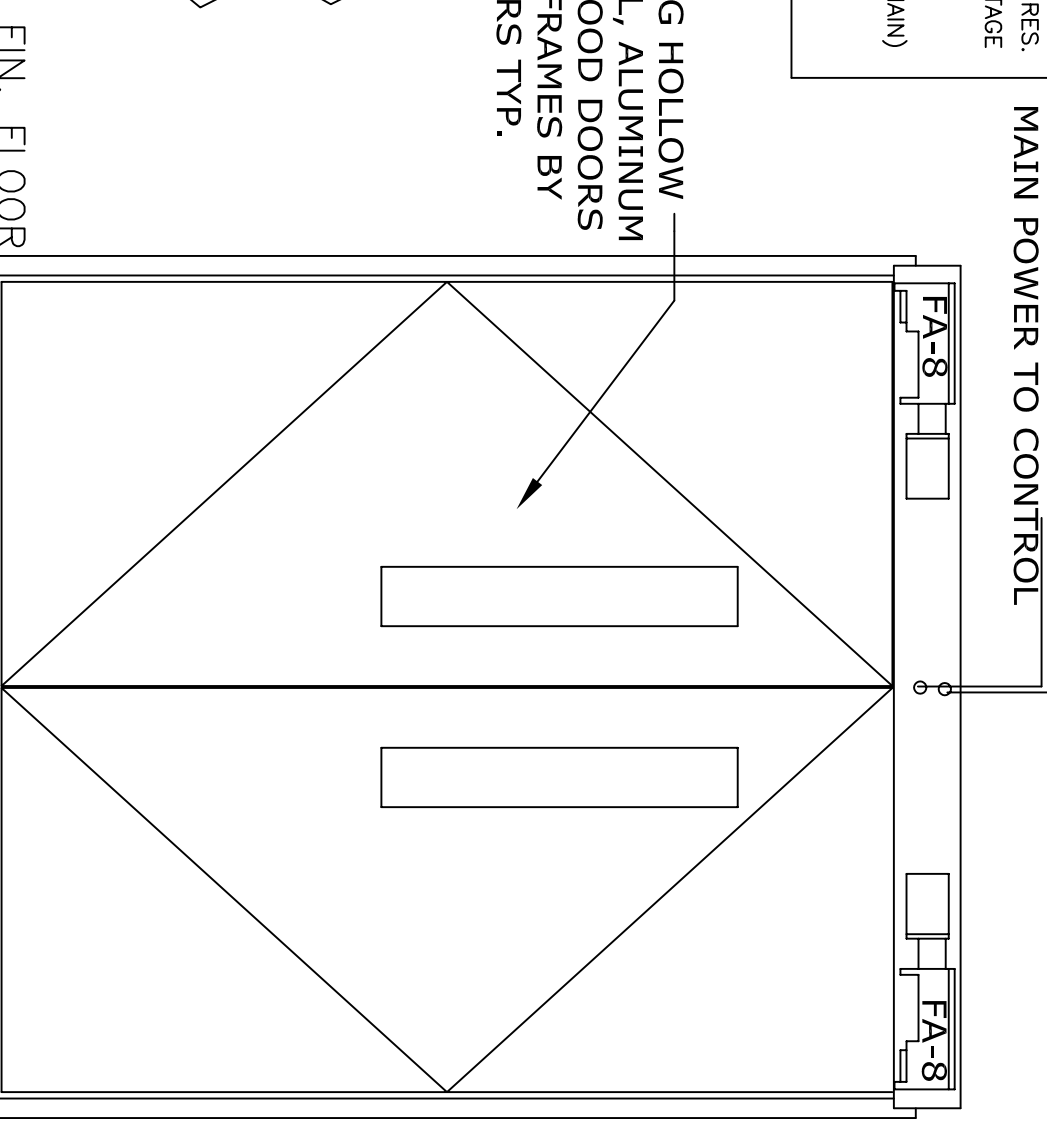

ELEVATION

ACCESS HOLES
TYP. 1" DIA. FOR
CONDUIT FITTING.

FIN. FLOOR

FIN. FLOOR

NOTE:
HUNTER ACCESS TECHNOLOGIES INC. RESERVES
THE RIGHT TO CHANGE & IMPROVE ITS
PRODUCTS & SPECIFICATIONS WITHOUT NOTICE.



125 KENYON DRIVE
SUITE #3
LAKEWOOD, NJ 08701
TEL: 732-942-6099
FAX: 732-942-6033
www.hunteraccesstechnologies.com

SHEET TITLE:

SHEET NO.

ARCHITECT:

16

CONTRACTOR:

SECTION

SCALE:

DRAWN BY:

DATE:

FA